

SPECIFICATIONS

Housing: Spun aluminum .090" thick. See Finish Note.

Reflector: Spun aluminum .040" thick, finished bright anodized.

Ballast: H.I.D.: prewired C.W.A., H.P.F. core and coil with capacitor and starter for HPS.

Lamp: Clear or phosphor coated H.I.D. 50, 70 & 100 watt metal halide medium base all others mogul base (by others).

Lamp Holder: H.I.D.: high heat porcelain w/nickel plated copper screw shell, spring loaded center contact, lamp grips, SF-2 leads (200° C). Impregnated gasket.

Lens: Prismatic acrylic, polycarbonate or heat resistant high impact borosilicate glass refractor.

Lens Frame: Injection molded nylon ring, gasketed, retains lens. Spun aluminum for glass refractor. Torsion spring lock-up with safety chain.

Cross Bar: 4" Long, tapped 3/8" I.P.S. galvanized steel. Surface mount only.

Quick Connect Box: 16 Gauge (.059") galvanized steel finished to match housing. See finish note.

Canopy Set: (Pendant Mount) 0-45° hang straight for 3/8" x 12" long steel pipe standard length with P2 accessory. Finished to match housing.**

Wall Bracket Assembly: One-piece cast aluminum bracket/arm assembly with access plate for wire inspection. Cast aluminum, wall mounting plate with 1/4" thick neoprene gasket. Quick disconnect wiring harness. Esco's **EZ5 Mounting System** allows the contractor to install the fixture in 5 minutes or less. Finished same as housing. See finish note.

Finish: All painted parts are washed in alkaline solution, rinsed in an iron phosphate, baked dry, then painted with a TGIC polyester powder coating electrostatic applied and baked.

Labels: Surface and wall mount suitable for wet location; pendant mount suitable for damp location. ETL, CETL and I.B.E.W. labeled.

Photometric Information: Contact factory.

Fixture Warranty: The fixture mechanics are guaranteed to be free from defective material and workmanship, under normal installation and operating conditions, for ten years from date of shipment from the factory. See General Terms and Conditions.

**Canopy set for indoor applications only; contact factory for other applications and designs.

SPECIFICATIONS SUBJECT TO CHANGE WITHOUT NOTICE



DIMENSIONS

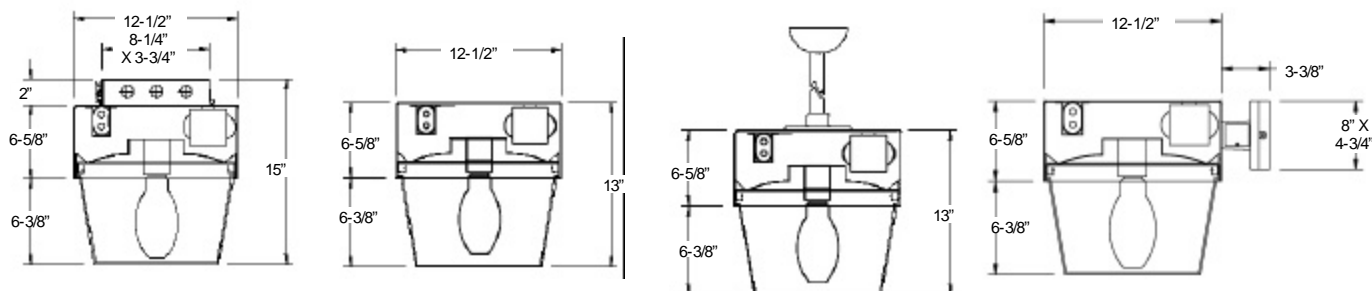

3254 North Kilbourn Avenue Chicago, Illinois 60641-4505
Phone: 773-427-7000 Fax: 800-217-1260 www.escolighting.com
A Woman-Owned Business
Established 1975



HOW TO ORDER

Prismatic Acrylic	Mounting System	Light Source	Watts	Prismatic Polycarbonate	Mounting System	Light Source	Watts	Prismatic Borosilicate Glass	Mounting System	Light Source	Watts
S4012	Surface	HPS	50	S4112	Surface	HPS	50	S4212	Surface	HPS	50
S4013	Surface	HPS	70	S4113	Surface	HPS	70	S4213	Surface	HPS	70
S4014	Surface	HPS	100	S4114	Surface	HPS	100	S4214	Surface	HPS	100
S4022	Surface	MH	50	S4115	Surface	HPS	150	S4215	Surface	HPS	150
S4023	Surface	MH	70	S4122	Surface	MH	50	S4222	Surface	MH	50
S4024	Surface	MH	100	S4123	Surface	MH	70	S4223	Surface	MH	70
W4012	Wall	HPS	50	S4124	Surface	MH	100	S4224	Surface	MH	100
W4013	Wall	HPS	70	S4125	Surface	MH	150*	S4225	Surface	MH	150*
W4014	Wall	HPS	100	S4126	Surface	MH	175*	S4226	Surface	MH	175*
W4022	Wall	MH	50	S41215	Surface	MH Pulse Start	150*	S42215	Surface	MH Pulse Start	150*
W4023	Wall	MH	70	S41217	Surface	MH Pulse Start	175*	S42217	Surface	MH Pulse Start	175*
W4024	Wall	MH	100	W4112	Wall	HPS	50	W4212	Wall	HPS	50
				W4113	Wall	HPS	70	W4213	Wall	HPS	70
				W4114	Wall	HPS	100	W4214	Wall	HPS	100
				W4115	Wall	HPS	150	W4215	Wall	HPS	150
				W4122	Wall	MH	50	W4222	Wall	MH	50
				W4123	Wall	MH	70	W4223	Wall	MH	70
				W4124	Wall	MH	100	W4224	Wall	MH	100
				W4125	Wall	MH	150*	W4225	Wall	MH	150*
				W4126	Wall	MH	175*	W4226	Wall	MH	175*
				W41215	Wall	MH Pulse Start	150*	W42215	Wall	MH Pulse Start	150*
				W41217	Wall	MH Pulse Start	175*	W42217	Wall	MH Pulse Start	175*

Mounting Options Suffix catalog number with:

B= Quick connect splice box.

P7x= Pendant and canopy mount
(x = required stem length in inches).

Voltage Suffix

- 1= 120V
- 2= 208V
- 3= 240V
- 4= 277V
- 5= 480V
- 8= Multi-Tap
wired for
277V
- 9= Multi-Tap
unwired
- 0= 347V

Color Suffix

- BZ= Textured Bronze
- BL= Textured Black
- W= Sky White

Other Consult
Factory

* Wall mount, pendant mount or quick connect splice box mount only.

EXAMPLE: S4122BLP724-1 = Surface mount, prismatic polycarbonate lens, 50 watt metal halide, textured black, pendant mount with 24" stem, 120V.



3254 North Kilbourn Avenue Chicago, Illinois 60641-4505
Phone: 773-427-7000 Fax: 800-217-1260 www.escolighting.com
A Woman-Owned Business
Established 1975

