

ESCO

LIGHTING, INC.



SX4500 Series

Indoor / Outdoor

*EZ5® Mounting System

Wall, Surface or Pendant Mount

Aluminum Area Luminaire

H.I.D. or CFL

SPECIFICATIONS

Housing

Extruded aluminum 6063 T5, .090" thick. * See finish note.

Reflector

Spun aluminum .040" thick, finished bright anodized.

Ballast

H.I.D.: prewired C.W.A., H.P.F. core and coil with capacitor and starter for HPS. Fluorescent: electronic with super lamp guard circuitry.

Lamp: Clear or phosphor coated H.I.D. medium base or compact fluorescent (by others).

Lamp Holder

H.I.D.: high heat porcelain w/nickel plated copper screw shell, spring loaded center contact, lamp grips, SF-2 leads (200° C). Impregnated gasket.

Fluorescent: 4 pin GX24q-4 base (see ordering information).

Door Frame

Die cast aluminum, silicone gasketed to seal out contaminants. Attached to cylinder with four stainless steel screws.

Canopy Set* (Pendant Mount) 0-45° hang straight for 3/8" x 12" long

steel pipe standard length with P2 accessory. Other lengths available. Finished to match housing.



EZ5® Surface Mount

Cast Aluminum 5/32" thick EZ5® splice box mounts to standard 4" octagonal junction box. Safety clip supports cylinder for hands free splice connection. Three #10-32 screws set 120° apart for twist and lock-up of cylinder to splice box. Supplied with quick-connect wiring harness. Escos's EZ5® design allows the contractor to install the fixture in 5 easy minutes or less. See illustration above. Finished same as housing.

EZ5® Wall Bracket Assembly

One-piece cast aluminum bracket / arm assembly with access plate for wire inspection. Cast aluminum, wall mounting plate with 1/4" thick neoprene gasket. Quick disconnect wiring harness. Escos's EZ5® Mounting System allows the contractor to install the fixture in 5 minutes or less. Finished same as housing. See finish note.

Finish

Detergent cleaned with iron phosphate and chromic acid rust inhibitor. Chip resistant powder urethane polyester coating, electro-static applied and baked. Standard colors textured black, textured bronze and sky white. Custom colors are available. Consult factory or sales representative.

Fixture Warranty

The fixture mechanics are guaranteed to be free from defective material and workmanship, under normal installation and operating conditions, for ten years from date of shipment from the factory. See General Terms and Conditions.

Photometric Information

Contact factory.

*Canopy set for indoor applications only; contact factory for other applications and designs.

SPECIFICATIONS SUBJECT TO CHANGE WITHOUT NOTICE



Pendant Mount

EZ5® Surface Mount



EZ5® Wall Mount

SX4500 Series

H.I.D. or CFL

Aluminum Area Luminaire

DIMENSIONS

EZ5® Surface Mount

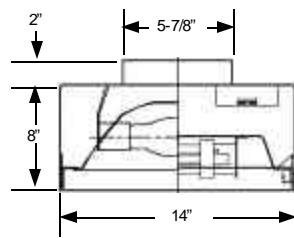

EZ5® Wall Mount

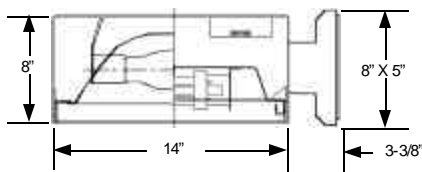

Pendant Mount

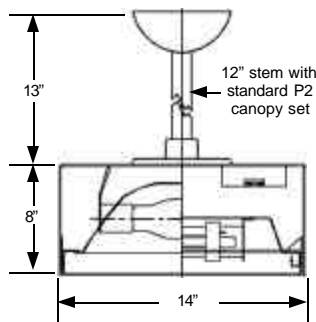

Certifications and Labels

ETL, CETL listed
I.B.E.W. assembled and labeled
ARRA Compliant

Energy Data

H.I.D. / Compact Fluorescent

H.I.D.:
HX-HPF M90/140 127/220V C&C 60Hz
CSA, NOM, RoHS
Compact Fluorescent:
Electronic Ballast 120-277V, 50/60Hz
Sound Rated A, Class P, Type I Outdoor
Complies FCC47 CFR Part 18, Non-consumer



WBE City of Chicago Certified

2324 North Kilbourn Avenue Chicago, Illinois 60641-4505
Phone: 773-427-7000 Fax: 800-217-1260 www.escolighting.com
Established 1975









HOW TO ORDER

Catalog Number	Light Source	Wattage / Lamp Base
SX4522	Metal Halide	50W Medium Base
SX4523	Metal Halide	70W Medium Base
SX4524	Metal Halide	100W Medium Base
SX4526	Metal Halide	175W Medium Base
SX45DL26	Compact Fluorescent	1-26W / GX24q-4
SX45D226	Compact Fluorescent	2-26W / GX24q-4

Catalog Number	Light Source	Wattage / Lamp Base
SX45T26	Compact Fluorescent	1-26W / GX24q-4
SX45T226	Compact Fluorescent	2-26W / GX24q-4
SX45T32	Compact Fluorescent	1-32W / GX24q-4
SX45T232	Compact Fluorescent	2-32W / GX24q-4
SX45T42	Compact Fluorescent	1-42W / GX24q-4
SX45T242	Compact Fluorescent	2-42W / GX24q-4

ACCESSORIES AND OPTIONS

	Photo Control* Suffix Catalog number with 120 Volt = PC4 208-277 Volt = PC5 Example: SX4523 becomes : SX4523PC4
	Fuse and Fuse Holder* Suffix Catalog Number With F Example: SX4523 becomes : SX4523F

	EZ5® Wall Mount Change Prefix SX to WXB Example: SX4523 becomes : WXB4523
	Pendant Mount Suffix Catalog Number With P2 =12" long stem (standard) P2X ="X" is custom stem length Example: SX4523 becomes : SX4523P2

*Voltage Suffix

120 or 277 volt must be specified when ordering a Photo Control, Fuse and Fuse Holder or Occupancy Sensor.

- 1= 120V
- 2= 208V
- 3= 240V
- 4= 277V
- 5= 480V
- 8= Multi-Tap Prewired for 277V
- 9= Multi-Tap Unwired
- 0= 347V

Example: SX4524 becomes : SX4524-1

EXAMPLE: SX453T242BLP724-1 = Surface mount, 2-fluorescent PLT 42W lamps, textured black, pendant mount with 24" stem, 120V.

Finish Color Options

Textured Black=**BL**, Textured Bronze=**BZ**, Sky White=**W**



WBE City of Chicago Certified

3254 North Kilbourn Avenue Chicago, Illinois 60641-4505
 Phone: 773-427-7000 Fax: 800-217-1260 www.escolighting.com
Established 1975

