

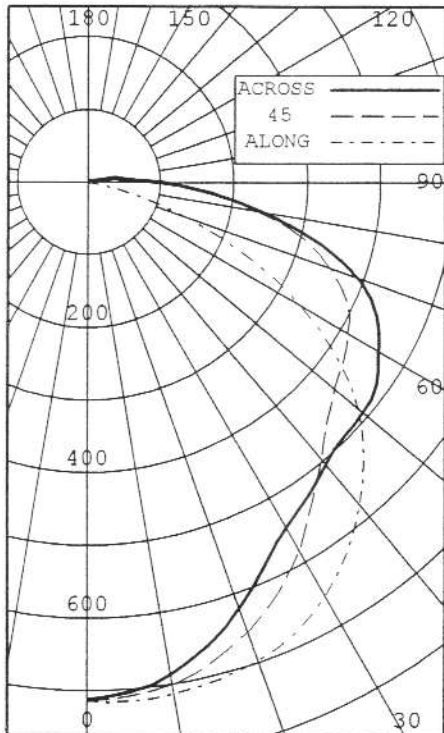

CERTIFIED TEST REPORT No. 24717

ESCO LIGHTING INC - WALLMOUNT LUMINAIRE, CAT# WPD840
WITH WHITE INTERIOR, SPECULAR REFLECTOR AND CLEAR FLAT GLASS LENS
PHILIPS 85 WATT INDUCTION LAMP, CAT# QL85W/830. LUMINAIRE LUMEN OUTPUT = 2463 LMS.
ONE PHILIPS QL85W 100-120V HF GENERATOR OPERATING AT 120 VAC AND 72 WATTS

INTENSITY (CANDLEPOWER) SUMMARY OUTPUT LUMENS



ANGLE	ALONG	22.5	45	67.5	ACROSS	OUTPUT LUMENS
0	713	713	713	713	713	
5	717	714	710	707	705	68
15	707	700	680	662	655	192
25	679	660	619	588	577	287
35	619	588	535	524	526	347
45	534	484	463	489	495	377
55	414	363	426	471	482	381
65	242	259	391	421	436	348
75	73	170	307	324	330	263
85	2	75	169	192	172	143
90	0	35	104	128	102	
95	0	9	49	73	55	47
105	0	0	6	15	16	9
115	0	0	0	3	4	1
125	0	0	0	0	0	0
135	0	0	0	0	0	0
145	0	0	0	0	0	0
155	0	0	0	0	0	0
165	0	0	0	0	0	0
175	0	0	0	0	0	0
180	0	0	0	0	0	0

ZONE	LUMENS	% LAMP	% LUMINAIRE
0-30	547	22.21	22.21
0-40	894	36.30	36.30
0-60	1651	67.06	67.06
0-90	2406	97.67	97.67
40-90	1511	61.38	61.38
60-90	754	30.62	30.62
90-180	57	2.33	2.33
0-180	2463	100.00	100.00

** EFFICACY: 34.2 LUMENS/WATT **

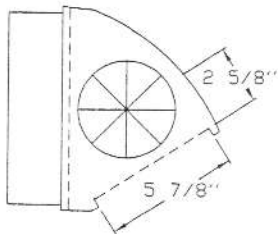

LUMINANCE SUMMARY CD./SQ.M.

ANGLE	ALONG	45	ACROSS
45	14380	12520	13385
55	13757	14191	16064
65	10905	17665	19710
75	5407	22633	24395
85	361	37056	37718

S/MH: 1.1
SC (ALONG): 1.4, SC (ACROSS): 1.1

CERTIFIED BY:

Ryden Summary DATE: JAN 19, 2009

PREPARED FOR:

ESCO LIGHTING INC
CHICAGO, IL.

TESTED IN ACCORDANCE WITH IES PROCEDURES.

LIGHTING SCIENCES, INC.
 7826 E. EVANS RD.
 SCOTTSDALE, AZ, USA 85260

CERTIFIED TEST REPORT No. 24717

ESCO LIGHTING INC - WALLMOUNT LUMINAIRE, CAT# WPD840
 WITH WHITE INTERIOR, SPECULAR REFLECTOR AND CLEAR FLAT GLASS LENS
 PHILIPS 85 WATT INDUCTION LAMP, CAT# QL85W/830. LUMINAIRE LUMEN OUTPUT = 2463 LMS.
 ONE PHILIPS QL85W 100-120V HF GENERATOR OPERATING AT 120 VAC AND 72 WATTS

AVERAGE LUMINANCE DATA

ANGLE	ALONG	CD./SQ.M.		(FOOTLAMBERTS)		ACROSS
		22.5	45	67.5		
0	13579(3963)	13579(3963)	13579(3963)	13579(3963)	13579(3963)	13579(3963)
30	14366(4192)	13833(4037)	12788(3732)	12126(3539)	12016(3507)	
40	14385(4198)	13436(3921)	12351(3604)	12605(3678)	12564(3667)	
45	14380(4197)	13048(3808)	12520(3654)	13205(3854)	13385(3906)	
50	14272(4165)	12613(3681)	13040(3806)	14145(4128)	14540(4243)	
55	13757(4015)	12083(3526)	14191(4142)	15677(4575)	16064(4688)	
60	12652(3692)	11790(3441)	15632(4562)	17374(5070)	17494(5105)	
65	10905(3182)	11696(3413)	17665(5156)	19018(5550)	19710(5752)	
70	8539(2492)	12199(3560)	19816(5783)	21052(6144)	22113(6454)	
75	5407(1578)	12588(3674)	22633(6605)	23906(6977)	24395(7120)	
80	2318(676)	13349(3896)	26503(7735)	28551(8333)	27351(7983)	
85	361(105)	16366(4776)	37056(10815)	42095(12286)	37718(11008)	

LIGHTING SCIENCES, INC.
 7826 E. EVANS RD.
 SCOTTSDALE, AZ, USA 85260

CERTIFIED TEST REPORT No. 24717

ESCO LIGHTING INC - WALLMOUNT LUMINAIRE, CAT# WPD840
 WITH WHITE INTERIOR, SPECULAR REFLECTOR AND CLEAR FLAT GLASS LENS
 PHILIPS 85 WATT INDUCTION LAMP, CAT# QL85W/830. LUMINAIRE LUMEN OUTPUT = 2463 LMS.
 ONE PHILIPS QL85W 100-120V HF GENERATOR OPERATING AT 120 VAC AND 72 WATTS

INTENSITY (CANDLEPOWER) DATA

ANGLE	PLANE						OUTPUT LUMENS
	ALONG	22.5	45	67.5	ACROSS	AVERAGE	
0	713	713	713	713	713	713	
5	717	714	710	707	705	711	68
10	714	709	701	691	685	700	
15	707	700	680	662	655	681	192
20	696	684	653	628	618	656	
25	679	660	619	588	577	624	287
30	653	627	580	550	546	589	
35	619	588	535	524	526	555	347
40	579	539	496	506	505	521	
45	534	484	463	489	495	488	377
50	482	424	440	476	491	457	
55	414	363	426	471	482	427	381
60	332	308	410	455	459	392	
65	242	259	391	421	436	352	348
70	153	218	355	377	397	306	
75	73	170	307	324	330	251	263
80	21	121	241	260	249	189	
85	2	75	169	192	172	131	143
90	0	35	104	128	102	79	
95	0	9	49	73	55	40	47
100	0	1	19	34	33	17	
105	0	0	6	15	16	7	9
110	0	0	2	6	7	3	
115	0	0	0	3	4	1	1
120	0	0	0	0	1	0	
125	0	0	0	0	0	0	0
130	0	0	0	0	0	0	
135	0	0	0	0	0	0	0
140	0	0	0	0	0	0	
145	0	0	0	0	0	0	0
150	0	0	0	0	0	0	
155	0	0	0	0	0	0	0
160	0	0	0	0	0	0	
165	0	0	0	0	0	0	0
170	0	0	0	0	0	0	
175	0	0	0	0	0	0	0
180	0	0	0	0	0	0	

LIGHTING SCIENCES, INC.
 7826 E. EVANS RD.
 SCOTTSDALE, AZ, USA 85260

CERTIFIED TEST REPORT No. 24717

ESCO LIGHTING INC - WALLMOUNT LUMINAIRE, CAT# WPD840
 WITH WHITE INTERIOR, SPECULAR REFLECTOR AND CLEAR FLAT GLASS LENS
 PHILIPS 85 WATT INDUCTION LAMP, CAT# QL85W/830. LUMINAIRE LUMEN OUTPUT = 2463 LMS.
 ONE PHILIPS QL85W 100-120V HF GENERATOR OPERATING AT 120 VAC AND 72 WATTS

COEFFICIENTS OF UTILIZATION

ZONAL CAVITY METHOD

EFFECTIVE FLOOR CAVITY REFLECTANCE = .20

CC WALL	90				80				70				50				30				10				0	
	70	50	30	10	70	50	30	10	70	50	30	10	50	30	10	50	30	10	50	30	10	50	30	10	0	
RCR	0	1.221	.221	.221	.22	1.191	.191	.191	.19	1.151	.151	.151	.15	1.101	.101	.101	.10	1.051	.051	.051	.05	1.001	.001	.001	.00	0.98
	1	1.101	.030	.980	.94	1.071	.010	.960	.92	1.040	.990	.940	.90	0.940	.900	.87	0.890	.860	.84	0.850	.830	.81	0.78	0.78	0.78	0.78
	2	0.990	.900	.820	.75	0.960	.880	.800	.74	0.940	.850	.780	.73	0.810	.760	.71	0.780	.730	.69	0.740	.700	.67	0.64	0.64	0.64	0.64
	3	0.900	.780	.690	.61	0.870	.760	.680	.61	0.850	.740	.660	.60	0.710	.640	.59	0.680	.620	.57	0.650	.600	.56	0.54	0.54	0.54	0.54
	4	0.830	.690	.590	.52	0.800	.680	.590	.52	0.780	.660	.580	.51	0.630	.560	.50	0.610	.540	.49	0.580	.530	.48	0.46	0.46	0.46	0.46
	5	0.760	.620	.520	.44	0.740	.600	.510	.44	0.710	.590	.500	.43	0.560	.490	.43	0.540	.470	.42	0.520	.460	.41	0.39	0.39	0.39	0.39
	6	0.700	.550	.450	.38	0.680	.540	.440	.38	0.650	.520	.440	.37	0.500	.430	.37	0.480	.420	.36	0.470	.400	.36	0.34	0.34	0.34	0.34
	7	0.640	.490	.390	.33	0.620	.480	.390	.33	0.600	.470	.380	.32	0.450	.370	.32	0.430	.360	.31	0.420	.360	.31	0.29	0.29	0.29	0.29
	8	0.590	.440	.350	.29	0.570	.430	.350	.29	0.560	.420	.340	.28	0.410	.330	.28	0.400	.330	.28	0.380	.320	.27	0.25	0.25	0.25	0.25
	9	0.550	.400	.310	.25	0.530	.400	.310	.25	0.520	.390	.310	.25	0.370	.300	.25	0.360	.290	.24	0.350	.290	.24	0.22	0.22	0.22	0.22
	10	0.510	.370	.280	.22	0.490	.360	.280	.22	0.480	.350	.280	.22	0.340	.270	.22	0.330	.260	.22	0.320	.260	.21	0.19	0.19	0.19	0.19

LUMINAIRE INPUT WATTS = 72.0

LABORATORY RESULTS MAY NOT BE REPRESENTATIVE OF FIELD PERFORMANCE.
 BALLAST AND FIELD FACTORS HAVE NOT BEEN APPLIED.

TEST DISTANCE EXCEEDS FIVE TIMES THE GREATEST
 LUMINOUS OPENING OF LUMINAIRE.